

MOZA RACING



Quick Guide

FSR Formula Wheel

Behind You Is No One



User manual 使用说明书

01 Product introduction

- 280mm width Formula-style Wheel
- 4.3-inch HD Display
- 12+ professional Formula-style UI interfaces
- Hand-stitched perforated leather
- High-strength carbon fiber frame and shifters
- Aluminum Alloy Back Shell
- Carbon Fiber Photoelectric Double Clutch Paddles
- Quick Release System
- Flow RGB Shift Indicator Lighting
- Can be directly connected to PC via USB (optional)
- Ergonomic Design
- 10 illuminated programmable mechanical keys
- 5 band knobs, 2 thumb knobs, 2 universal joysticks

02 Quick Release Instructions

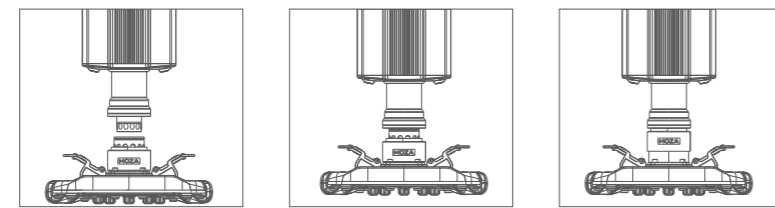

1. Align the 6 steel balls on the steering wheel with the 6 grooves on the wheelbase.
2. Press the wheel into the wheelbase, keeping the balls aligned with each other.
3. The quick release will automatically snap into place, locking the wheel to the base. If the quick release does not lock, try rotating the panel on the base to its default position, and try again until it locks correctly.
4. To remove the wheel from the base, simply use two hands to pull back on the outer ring (black color) and pull the wheel out at the same time.

03 Wheel Configuration

- Using MOZA Pit House, our software suite, the FSR steering wheel can easily be set up and configured to your liking.
- Clutch Paddle Mode: Set the operation of the clutch paddles, which can be configured to act together or independently of each other, also as a button input
 - Joystick Mode: Joysticks can be configured as keys or buttons
 - Indicator Light Switch: Allows for switching the indicator light off, on, or specific speed settings
 - Indicator Light Display Mode: Divided into two modes, toggled in the MOZA Pit house suite
 - Speed Adjustment: Adjustable according to speed and the timing of the shift indicator light, with different presets available
 - Brightness Adjustment: Allows for adjusting of the brightness of the shift indicator
 - UI Interface Configuration: You can switch UI in the MOZA Pit House suite, or you can switch the UI on the wheel directly by pressing the lower right dual-clutch paddle while moving the joystick left or right.
 - Steering Wheel Combination Key Configuration: Click on the description of the combination key in the upper right corner of the steering wheel picture, allowing for adjustments of the function.
 - Indicator Light Color Adjustment: Adjust the color of the MOZA Flow shifter according to your preferences.
 - Screen Brightness: Adjust the brightness of the display on the steering wheel.
 - Speed Unit: Can be set to Metric or Imperial.
 - Temperature Unit: Can be set to Celsius and Fahrenheit.

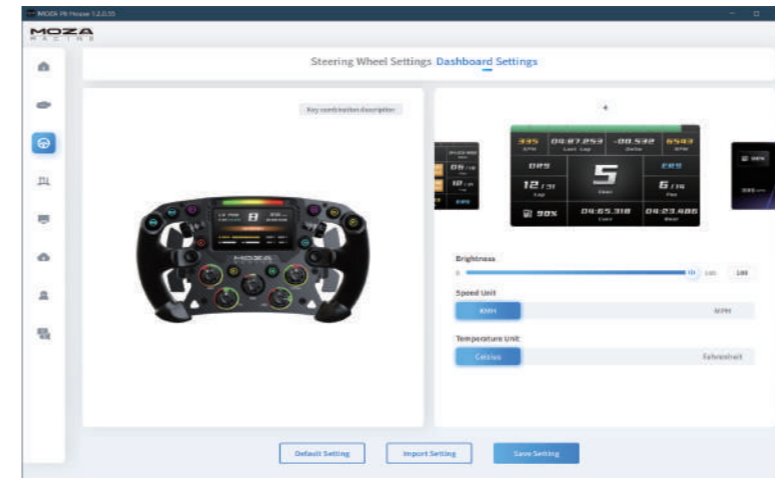
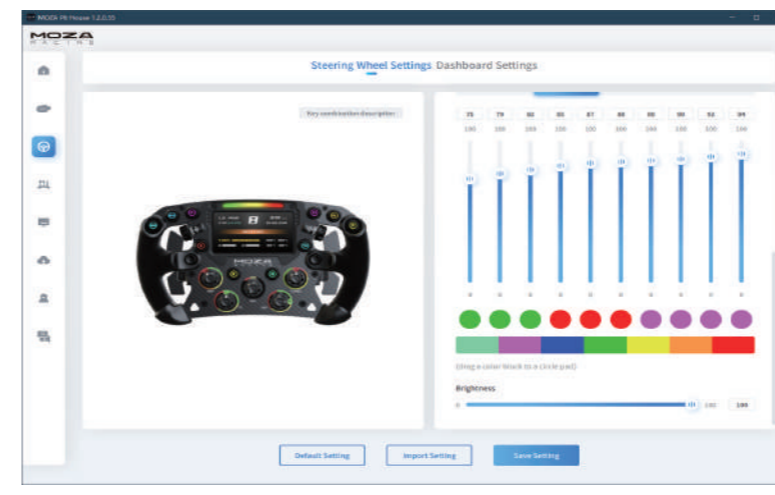
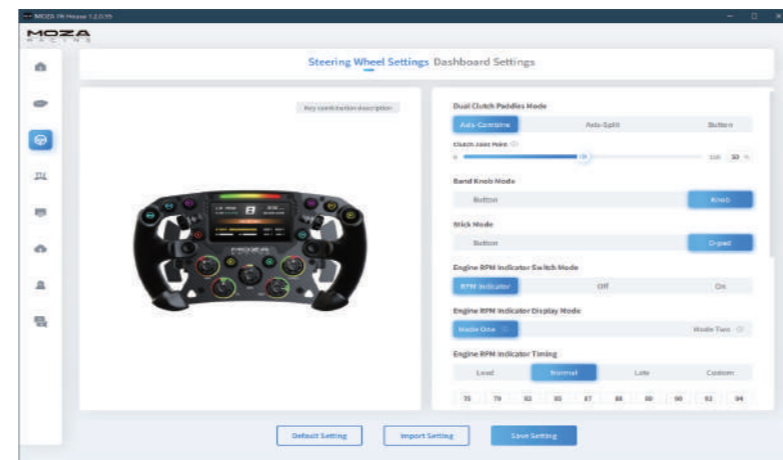

(For further information on specific steering wheel settings or functions using the MOZA Pit House Suite, visit our official website at www.mozaracing.com)

04 Key combination description



- Left clutch paddle + press the left rocker
Switching maximum steering angle of 360°
- Left clutch paddle + press the right rocker
Switching maximum steering angle of 540°
- Left clutch paddle + press BB thumb knob
Switching maximum steering angle of 720°
- Left clutch paddle + press ERS thumb knob
Switching maximum steering angle of 900°
- Left clutch paddle + toggle the left rocker to the left
Switching the dashboard UI to the previous UI
- Left clutch paddle + toggle left rocker to the right
Switching the dashboard UI to the next UI
- Right clutch paddle + toggle the left rocker to the left
Switching the dashboard UI to the previous UI
- Right clutch paddle + toggle the left rocker to the right
Switching the dashboard UI to the next UI
- Press both rockers at the same time
Switching left stick mode: cross key / normal button
- Press both thumb knobs simultaneously
Toggle button color

05 Installation of Magnetic Shifter Silencers

Place the steering wheel on a flat working surface, with the front side facing down. Use a hexagonal wrench to remove the screw on the side of the trigger lever of the shift paddle, then use a wrench to carefully lift the latch from the side of the magnetic paddle (NOTE: you do not need to push it out completely, only the magnetic paddle. The trigger lever and the latch can be separated). Apply the silencer pad on the back of the magnet hole and the raised position on the back of the paddle trigger lever, as shown in the figure, finally returning the latch into place, and replacing the screw. (Please do not apply the silencer pads below the raised position of the trigger lever because this is the area of the paddle photoelectric sensor switch and a silencer pad there will affect the normal use of shifter paddles) as shown in the figure, finally return the latch into place, and tighten the screws.

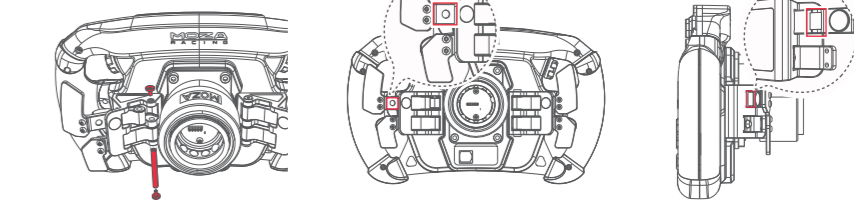

06 Packing list

1. FSR Racing Formula Wheel
2. Tool kit: Hexagon screwdriver / Silencer Pads x4
3. Portable cloth bag

07 Product parameters

Size: 280mm standard formula wheel
 Display size: 4.3 Inches
 Display Resolution: 800x480
 Grip Material: Leather
 Frame and Panel Material: 5mm thick carbon fiber
 Shifter Material: 3mm thick carbon fiber
 Back Shell Material: Aviation-grade Aluminum Alloy
 Shift Paddles: 2
 Dual-clutch Paddles: 2
 Illuminated Programmable Mechanical Keys: 10
 Thumb Joysticks (pressable): 2
 Band knobs: 5
 LED RGB Beads: 10 LED
 Count (Strip): 10 LEDs
 Smart Telemetry: Supported
 MOZA Pit House Light Configuration: Supported
 Quick Release: Supported
 Signal Transmission: Wireless
 Shifter Mode: Photoelectric Contactless
 Dual-clutch Paddle Mode: Simultaneous / Independent Axis / Button Input

01 产品介绍

- 280mm标准方程式盘宽度
- 4.3寸高清仪表
- 多达十几款专业方程式仪表盘UI界面
- 手工缝制打孔皮革面料
- 高强度东丽3K碳纤维骨架和拨片
- 铝合金外壳
- 碳纤维光电双离合拨片
- 定制赛车级快拆
- RGB流水式换挡提示灯
- 可USB直连PC (选装转换器)
- 人体工学设计
- 10个发光可编程机械键盘式按键
- 5个波段旋钮, 2个拇指旋钮, 2个方向摇杆

02 快拆使用方法

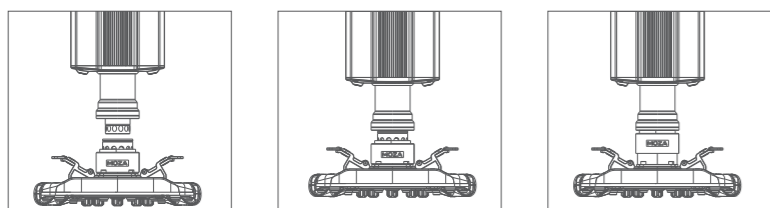

1. 将方向盘快拆母头上6颗钢珠的位置与底座快拆公头的6个凹槽对应
2. 将快拆往盘面方向按压
3. 快拆将自动归位锁紧, 若无归位, 可尝试轻微转动盘面或取下后再安装
4. 如需拆取盘面, 用双手捏住黑色快拆部分, 同时并拔出盘面

03 方向盘设置

- 在MOZA Pit House软件中可以方便快捷地对FSR方向盘进行设置。
- 离合拨片模式: 设置离合拨片操作模式, 可设置为合成轴, 独立轴和按键
 - 摇杆模式: 设置摇杆操作模式, 可设置为按键和十字键
 - 指示灯开关模式: 指示灯状态调节, 分为随速转动, 关闭和常亮
 - 指示灯显示模式: 共分为模式一和模式二, 当鼠标移动到选项上时会弹出详细解释
 - 转速提示设置: 根据转速与换挡指示灯亮起的时机关系, 分为提前型, 标准型, 极限型和自定义模式
 - 亮度调节: 调节换挡指示灯的亮度
 - 界面UI切换: 可在Pit House中下列界面切换UI, 也可通过按下左右双离合拨片的同时左右拨动摇杆实现切换
 - 方向盘组合键: 点开方向盘图片右上角的组合键说明, 记住组合键后即可快速调节功能
 - 指示灯颜色调节: 将喜欢的色块拖动到指示灯上即可更换颜色
 - 屏幕亮度: 调节方向盘上的显示屏亮度
 - 速度单位: 可设置为公制和英制
 - 温度单位: 可设置为摄氏度和华氏度

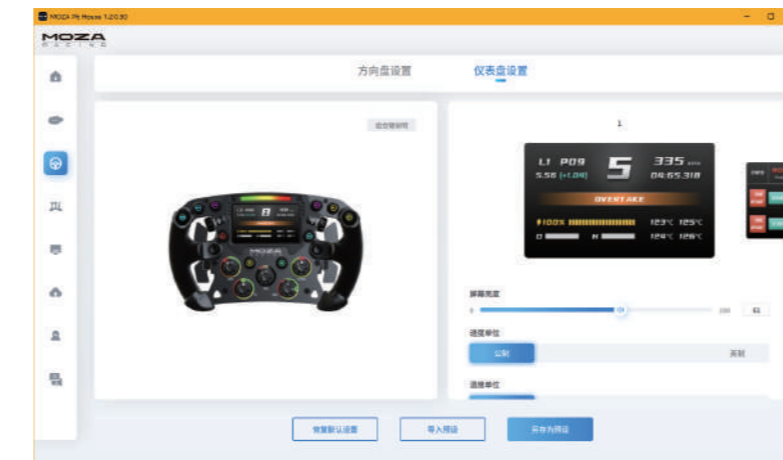

(详细方向盘设置与功能, 请访问MOZA Racing官网)

04 组合按键说明



- 左离合拨片+按下左侧摇杆
切换最大转向角为360°
- 左离合拨片+按下右侧摇杆
切换最大转向角为540°
- 左离合拨片+按下BB拇指旋钮
切换最大转向角为720°
- 左离合拨片+按下ERS拇指旋钮
切换最大转向角为900°
- 左离合拨片+向左拨动左摇杆
切换仪表盘UI到上一个UI
- 左离合拨片+向右拨动左摇杆
切换仪表盘UI到下一个UI
- 右离合拨片+向左拨动左摇杆
切换仪表盘UI到上一个UI
- 右离合拨片+向右拨动左摇杆
切换仪表盘UI到下一个UI
- 同时按下两个摇杆
切换左摇杆模式+字键/普通按键
- 同时按下两个拇指旋钮
切换按键颜色

05 磁吸拨片静音垫的安装

将方向盘放置于平面上使盘面朝下, 使用六角扳手取下换挡拨片触发杆一侧的螺丝, 再用扳手从磁吸拨片侧插入插销 (无需完全顶出, 仅使磁吸拨片触发杆与插销可以分离即可), 然后将静音垫贴在磁珠孔背面和拨片触发杆背面凸起位置, 切勿将静音垫贴在触发杆凸起部位的下方 (此处为拨片光电开关感光区域, 静音垫覆盖上去会影响拨片功能) 如图所示, 最后将插销归位并装回螺丝。

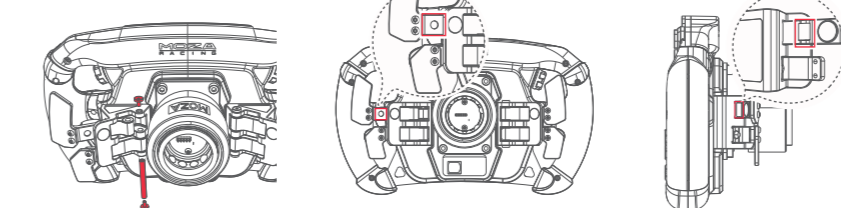

06 包装清单

1. FS方向盘
2. 工具包: 六角螺丝刀 / 静音垫x4
3. 便携布袋

07 产品参数

尺寸: 280mm标准方程式盘尺寸
 显示屏尺寸: 4.3英寸
 显示屏分辨率: 800x480
 环身材质: 皮质
 骨架和面板材质: 5mm厚碳纤维
 拨片材质: 3mm厚碳纤维
 后壳材质: 航空级铝合金
 换挡拨片: 2个
 双离合拨片: 2个
 发光机械键盘式按键: 10个

拇指旋钮 (可按压): 2个
 波段旋钮: 5个
 高亮LED RGB灯珠: 10颗
 LED色彩: 7色自定义
 智能遥测: 支持
 通过MOZA Pit House设置灯光: 支持
 拆装方式: 现实赛车快拆
 信号传输方式: 无线
 拨片感应方式: 光电无接触式
 双离合拨片模式: 合成轴/独立轴/按键

产品保修卡

产品型号		购买日期	
用户姓名		用户电话	
产品条码		通讯地址	

经销商信息 (签章)

产品保修条例

保修期

自购机日起, 底座主体, 方向盘, 踏板和仪表显示屏保修12个月, 设备外壳、说明书、线材、螺丝、扳手、包装等不在“一年免费维修服务”范围内, 但您可以选择有偿服务。购买者在以下条件下不享受免费维修服务, 但您可以选择有偿服务。

1. 超过三包有效期的;
 2. 无三包凭证及有效发票的, 但能够证明该产品在三包有效期内的除外;
 3. 保修凭证上的型号与修理产品型号不符或者涂改的;
 4. 非本公司特约维修人员拆卸造成损坏的;
 5. 因不可抗力造成损坏的;
 6. 未按产品使用说明书要求使用、维护、保养而造成损坏的。
- 保修期限鉴于产品部位、不同国家法律法规等差异, 将有所不同, 相关国家与区域的保修期限, 请咨询MOZA官方或购买时联系的MOZA授权经销商。



尺寸: 126*180mm

材质: 80G书写纸(折页)