

TSW Steering Wheel



01 Product Features

- 400mm Standard Truck Wheel
- Hand-stitched Microfiber Leather Grips
- Aviation-grade Aluminum Rim
- Programmable RGB Back-lit Buttons
- All-aluminum Quick Release
- Direct Connection to PC

02 QR Use Guide

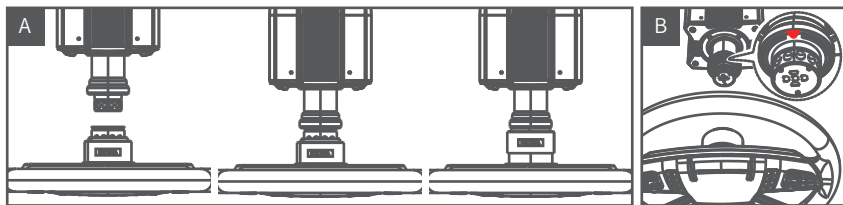

Method A:

- Align the 6 ball bearings on the wheel QR with the 6 notches on the base QR mount.
- Press the quick release onto the base mount, keeping the bearings and notches aligned.
- The quick release will automatically lock into place; if it doesn't, then remove it, recheck the alignment and try again.
- To remove the wheel, squeeze the black quick release part with the MOZA logo towards the wheel with both hands and pull out the wheel at the same time.

Method B:

- Rotate the wheelbase until you locate the arrow directly above the base.
- Center the wheel and attach it to the wheelbase.
- To remove the wheel, use both hands to squeeze the black quick release part with the MOZA logo towards the wheel with both hands and pull out the wheel at the same time.

03 Steering Wheel Configuration

The wheel can be set up quickly and easily in the MOZA Pit House software.

- Joystick modes: can be set to button or D-pad.
- RPM indicator switch modes: choice of three modes: rpm, off and constant.
- Indicator modes: there are two modes, mode 1 and mode 2; both are explained in detail when the mouse is hovered over the corresponding option.
- RPM indicator timing: choose between early, normal, late or custom to fully match in-game RPM timing.
- Brightness: adjust the brightness of the RPM/ shift LEDs.
- Button combinations: click on the button combination description tab on the upper right

corner of the steering wheel page to show a list of button input numbers and programming input combinations.

- RPM light color: drag the color block onto corresponding the RPM light to change its colors.

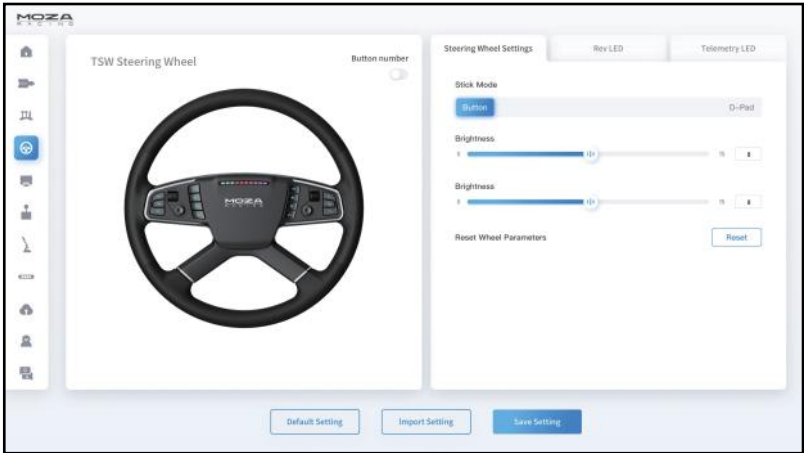

(for detailed steering wheel settings and functions, please visit the official website of MOZA Racing)

04 Package Content

1. MOZA TSW Truck Wheel
2. MOZA stickers

05 Spec

- Size: 400mm
- Wheel rim material: Aluminum
- Short-travel Backlit Buttons: 14
- Thumb Encoders: 2
- 4-way Switch: 2
- High Brightness RGB LEDs: 10
- LED Colors: Multiple customizable colors
- Intelligent Telemetry: Supported
- RPM LEDs Fully Adjustable through Moza Pit House: Supported
- Release Method: All-aluminum quick release
- Communication Method: Wireless and wired
- Compatibility: Compatible with all MOZA bases; works with 3rd party bases via the MOZA hub.