

FSR Formula Wheel

Behind You Is No One



01 Product introduction

- 280mm width Formula-style Wheel
- 4.3-inch HD Display
- 12+ professional Formula-style UI interfaces
- Hand-stitched perforated leather
- High-strength carbon fiber frame and shifters
- Aluminum Alloy Back Shell
- Carbon Fiber Photoelectric Double Clutch Paddles
- Quick Release System
- Flow RGB Shift Indicator Lighting
- Can be directly connected to PC via USB (optional)
- Ergonomic Design
- 10 illuminated programmable mechanical keys
- 5 band knobs, 2 thumb knobs, 2 universal joysticks

02 Quick Release Instructions

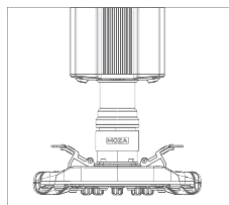
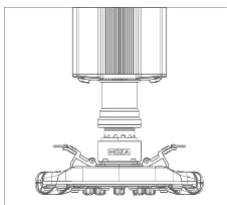
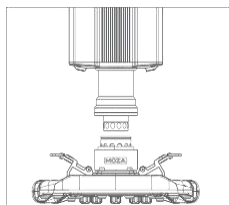

1. Align the 6 steel balls on the steering wheel with the 6 grooves on the wheelbase.
2. Press the wheel into the wheelbase, keeping the balls aligned with each other.
3. The quick release will automatically snap into place, locking the wheel to the base. If the quick release does not lock, try rotating the panel on the base to its default position, and try again until it locks correctly.
4. To remove the wheel from the base, simply use two hands to pull back on the outer ring (black color) and pull the wheel out at the same time.

03 Wheel Configuration

Using MOZA Pit House, our software suite, the FSR steering wheel can easily be set up and configured to your liking.

- Clutch Paddle Mode: Set the operation of the clutch paddles, which can be configured to act together or independently of each other, also as a button input
- Joystick Mode: Joysticks can be configured as keys or buttons
- Indicator Light Switch: Allows for switching the indicator light off, on, or specific speed settings
- Indicator Light Display Mode: Divided into two modes, toggled in the MOZA Pit House suite
- Speed Adjustment: Adjustable according to speed and the timing of the shift indicator light, with different presets available
- Brightness Adjustment: Allows for adjusting of the brightness of the shift indicator
- UI Configuration: You can switch UI in the MOZA Pit House suite, or you can switch the UI on the wheel directly by pressing the lower right dual-clutch paddle while moving the joystick left or right.
- Steering Wheel Combination Key Configuration: Click on the description of the combination key in the upper right corner of the steering wheel picture, allowing for adjustments of the function.
- Indicator Light Color Adjustment: Adjust the color of the MOZA Flow shifter according to your preferences.
- Screen Brightness: Adjust the brightness of the display on the steering wheel.
- Speed Unit: Can be set to Metric or Imperial.
- Temperature Unit: Can be set to Celsius or Fahrenheit.

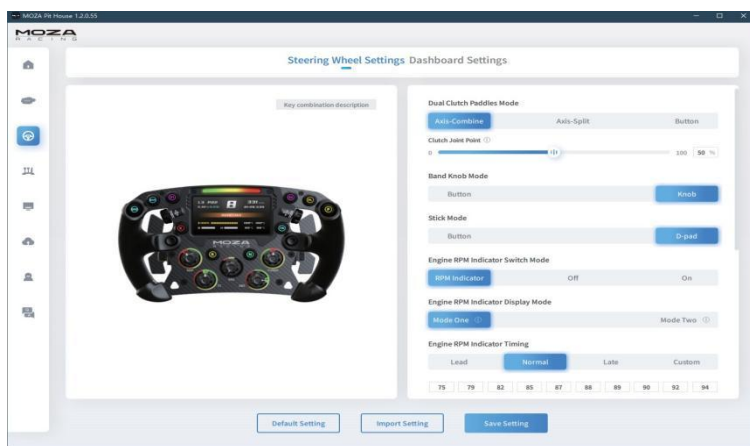

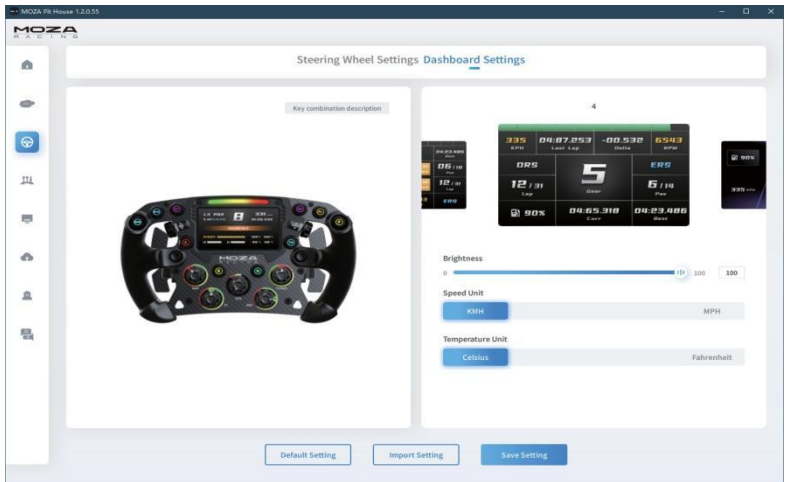
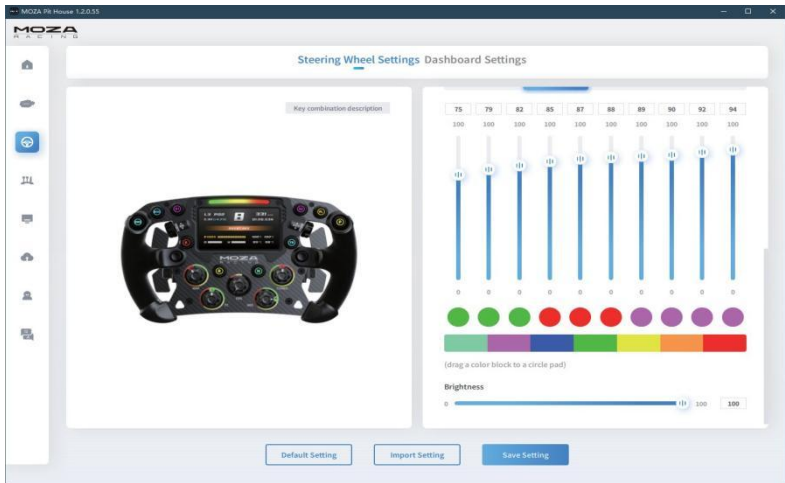

(For further information on specific steering wheel settings or functions using the MOZA Pit House Suite, visit our official website at www.mozaracing.com)

04 Key combination description



• Left clutch paddle+ press the left rocker
Switching maximum steering angle of 360°

• Left clutch paddle+ press the right rocker
Switching maximum steering angle of 540°

• Left clutch paddle+ press BB thumb knob
Switching maximum steering angle of 720°

• Left clutch paddle+ press ERS thumb knob
Switching maximum steering angle of 900°

• Left clutch paddle+toggle the left rocker to the left
Switching the dashboard UI to the previous UI

• Left clutch paddle+ toggle left rocker to the right
Switching the dashboard UI to the next UI

Right clutch paddle +
toggle the left rocker to the left
Switching the dashboard UI to the previous UI

Right clutch paddle +
toggle the left rocker to the right
Switching the dashboard UI to the next UI

Press both rockers at the same time
Switching left stick mode:
cross key / normal button

Press both thumb knobs simultaneously
Toggle button color

05 Installation of Magnetic Shifter Silencers

Place the steering wheel on a flat working surface, with the front side facing down. Use a hexagonal wrench to remove the screw on the side of the trigger lever of the shift paddle, then use a wrench to carefully lift the latch from the side of the magnetic paddle (NOTE: you do not need to push it out completely, only the magnetic paddle. The trigger lever and the latch can be separated). Apply the silencer pad on the back of the magnet hole and the raised position on the back of the paddle trigger lever, as shown in the figure, finally returning the latch into place, and tightening the screw. (Please do not apply the silencer pads below the raised position of the trigger lever because this is the area of the paddle photoelectric sensor switch and a silencer pad there will affect the normal use of shifter paddles)

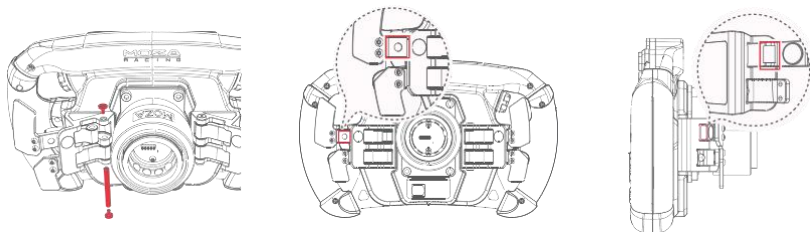

06 Packing list

1. FSR Racing Formula Wheel
2. Tool kit: Hexagon screwdriver / Silencer Pads x4
3. Portable Cloth Bag

07 Product parameters

Size: 280mm standard formula wheel Display size:

4.3 Inches

Display Resolution: 800x480 Grip

Material: Leather

Frame and Panel Material: 5mm thick carbon fiber Shifter

Material: 3mm thick carbon fiber

Back Shell Material: Aviation-grade Aluminum Alloy Shift

Paddles: 2

Dual-clutch Paddles: 2

Illuminated Programmable Mechanical Keys: 10 Thumb

Joysticks (pressable): 2

Band knobs: 5

LED RGB Beads: 10 LED

Count (Strip): 10 LEDs Smart

Telemetry: Supported

MOZA Pit House Light Configuration: Supported Quick

Release: Supported

Signal Transmission: Wireless

Shifter Mode: Photoelectric Contactless

Dual-clutch Paddle Mode: Simultaneous / Independent Axis / Button Input